

## Plastic Conical Anchors

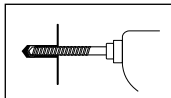

1. Drill hole full length of anchor or 1/8" deeper.

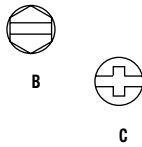
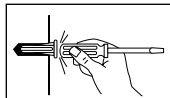

2. Tap anchor into hole flush with surface.

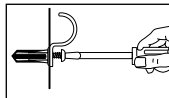

3. Insert screw through fixture into plastic plug and tighten.

- Light-duty, multi-size anchor for use in concrete, block, tile and brick.
- Use with sheet metal, wood and lag screws.
- Has collar for hollow materials.
- Moisture and chemical resistant, for indoor/outdoor use.
- Anchor kits include 100 anchors, 100 screws and one masonry bit.

### ANCHORS ONLY

CAT. NO.	UPC NO.	USE WITH	REQUIRED	QTY.	WEIGHT	
		SCREW SIZES	HOLE SIZE	PER BOX	LBS.	KG
84003	84003	#6 - #8	3/16"	100	.2	.1
84006	84006	#10, #12	1/4"	100	.2	.1

### ANCHORS KITS

CAT. NO.	UPC NO.	ANCHOR	SCREW	BIT	WEIGHT		
		SIZE	SIZE		TYPE	SIZE	LBS.
84009	84009	#6, #8	#8 x 1"	C	3/16"	.8	.4
84012	84012	#10, #12	#10 x 1"	C	1/4"	1	.5
84015	84015	#10, #12	#12 x 1"	C	1/4"	1.4	.6
84019	84019	#10, #12	#10 x 1"	B	1/4"	1.1	.5

## Masonry Screw Anchors



Masonry Screw Anchors must be used with Greenlee masonry screw drill bits, numbers 84484 and 84487, which are a special size to insure secure thread engagement. Standard masonry bit size holes will not provide proper contact with screw threads and may cause masonry anchor screws to pull out.

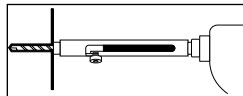

1. Use set Tool with bit in drilling position to drill hole in surface.

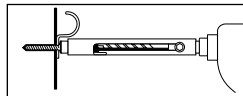

2. Retract bit, insert masonry screw into socket head of tool and drive screw into hole.

- A safe, secure, steel fastener that taps concrete and eliminates the need for concrete inserts with their alignment problems.
- Use with Greenlee masonry drill set tool.
- Use in concrete, block and brick.
- Quick and easy two-step installation, saves time.

### MASONRY SCREW ANCHORS – EACH BOX OF 100 INCLUDES 1 BIT

CAT. NO.	UPC NO.	SIZES	MATERIAL CONCRETE 3000 PSI			QTY.	WEIGHT	
			MIN. EMBEDMENT	PULLOUT LBS.	PULLOUT LBS.	PER BOX	LBS.	KG
84469	84469	1/4" x 1"	3/4"	1180	100	1.2	.5	
84475	84475	1/4" x 1-1/2"	1-1/4"	1800	100	1.6	.7	
84478	84478	1/4" x 2"	1-1/4"	1800	100	1.8	.8	
12350	12350	1/4" x 2-1/2"	1-1/4"	1800	100	2.1	1.0	

### INSTALLATION TOOLS

CAT. NO.	UPC NO.	DESCRIPTION	QTY.	WEIGHT	
			PER BOX	LBS.	KG
84466	84466	Masonry Screw Drill Set Tool with 84484 Bit	1	.4	.2
84484	84484	3-1/2" Masonry Screw Drill Bit – for use with 1" to 1-1/2" long screws	1	—	—

NOTE: For use in lightweight, hollow core concrete block, minimum embedment 1-3/8", pullout 715 lbs. Due to the variance in make-up of cement block, values will vary. It is suggested that the anchor be tested in specific material being used before installing fixtures.