

Non-Metallic Push-In Connectors

For NM and flexible cord. Easy push-in installation in a new work box*.



NM840



NM841



NMR840

CATALOG NUMBER	UPC/DCI/NAED MFG #018997	TRADE SIZE	KO SIZE	UNIT PKG	STD PKG	DIM A	DIM B	DIM C
NM840	54840	3/8	1/2	100	1000	1.031	.375	.965
NM841	54841	1/2	1/2	50	500	1.340	.475	1.125
NM842	54842	3/4	3/4	25	250	1.510	.475	1.200
NM843	54843	1	1	25	250	1.637	.475	1.500
NM844	50175	1-1/4	1-1/4	10	100	2.085	.475	2.012
NMR840*	14940	3/8	1/2	100	1000	1.030	.375	1.060

Refer to pages C-13 and C-14 for complete cable ranges.

*NMR840 can be installed INSIDE or OUTSIDE an installed box, in RETROFIT or NEW WORK.

*PATENT PENDING.

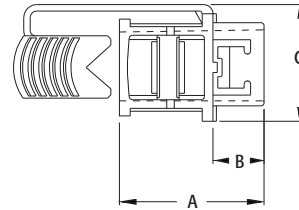

INSTALLATION INSTRUCTIONS



1 Disconnect electrical power. Push the connector into knockout.



2 Install required cables or cords.



3 Place wedge in connector slot and lock tight with a pair of pliers. Tightened wedge provides strong, positive grip.

NMR840 RETROFIT INSTALLATION INSTRUCTIONS (Inside Box)



1 Feed cable through the knockout, then in the connector.

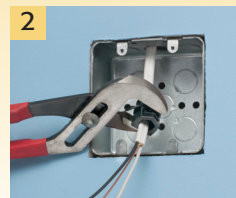

2 Insert wedge in slot in connector. Lock tight with pliers.



3 Push assembly into box...

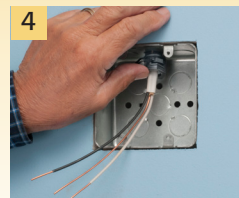

4 Done!

Non-Metallic Cable Connectors

For non-metallic sheathed cable. One piece construction. Listed for 1 or 2 cables. Holds cables securely and handles a wide range of cable sizes.



CATALOG NUMBER	UPC/DCI/NAED MFG #018997	TRADE SIZE	KO SIZE	UNIT PKG	STD PKG	DIM A	DIM B	DIM C
NM74	54510	3/8	1/2	100	1000	1.289	1.029	.875
NM75	54513	3/4	3/4	25	250	1.289	1.271	1.117

Refer to pages C-13 and C-14 for complete cable ranges.

PATENTED.

