

Bare Wire Ground Clamp with Closed Lug

Solid bronze with bronze screws. Approved for direct burial.

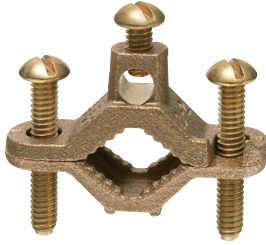

CATALOG NUMBER	UPC/DCI/NAED MFG #018997	PIPE SIZE	WIRE RANGE	UNIT PKG	STD PKG	DIM A	DIM B	MIN	MAX
720DB	00721	1/2 to 1	10-2	25	250	2.275	.312	.675	1.850

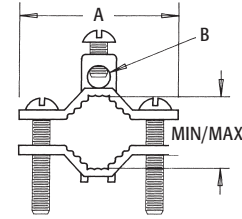

Bare Wire Ground Clamp

Solid bronze with stainless steel screws. Approved for direct burial on rebar, pipe, tubing, and rod.

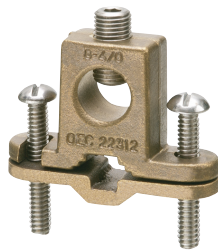

CATALOG NUMBER	UPC/DCI/NAED MFG #018997	PIPE SIZE	WIRE RANGE	UNIT PKG	STD PKG	DIM A	DIM B	MIN	MAX
718DB	72000	3/8 to 1	8-4/0	10	10	2.350	.620	.330	1.500

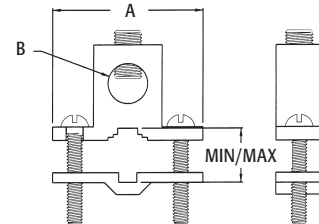

Bare Wire Ground Clamp with Open Lug

Solid bronze with stainless steel screws. Approved for direct burial on rebar, pipe, tubing, and rod.



CATALOG NUMBER	UPC/DCI/NAED MFG #018997	PIPE SIZE	WIRE RANGE	UNIT PKG	STD PKG	DIM A	MIN	MAX
719DB	72001	3/8 to 1	8-4/0	10	10	2.588	.360	1.125

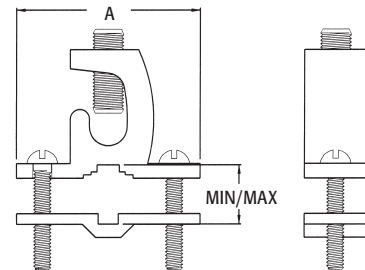

Bare Wire Ground Clamp with Open Lug

Solid bronze with stainless steel screws. Approved for direct burial on rebar, pipe, tubing, and rod.



CATALOG NUMBER	UPC/DCI/NAED MFG #018997	PIPE SIZE	WIRE RANGE	UNIT PKG	STD PKG	DIM A	MIN	MAX
717DB	12514	3/8 to 1	10-2	25	250	2.230	.275	1.500

