

## Rigid Conduit/IMC Fittings

### Pipe Straps — Malleable Iron/Zinc Plated

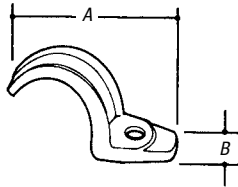

CAT. NO.	SCREW SIZE	CONDUIT SIZE (IN.)	DIMENSIONS (IN.)		STD. CTN.
			A	B	
HS-400	10	3/8	1 11/16	1 7/32	500
HS-401	1/4	1/2	2 1/64	5/8	500
HS-402	1/4	3/4	2 1/16	1 3/16	500
HS-403	1/4	1	2 5/8	1 5/16	100
HS-404-SC	5/16	1 1/4	3 1/16	1 1/32	100
HS-405	3/8	1 1/2	3 3/4	1 1/8	50
HS-406	1/2	2	4 19/32	1 1/16	25
HS-407	3/8	2 1/2	5 11/16	1 1/8	25
HS-408	3/8	3	6 7/8	1 1/8	25
HS-409	3/8	3 1/2	7 23/32	2 1/8	10
HS-410	3/8	4	8 7/16	2 3/8	10
HS-411	3/8	5	10 3/32	2 3/8	5

Available in one-hole and two-hole in Stainless Steel.

Add SS suffix to part number for Stainless Steel.

### Nail Strap — Stamped Steel/ Zinc Plated

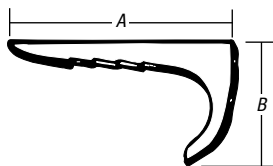

CAT. NO.	RIGID/MC SIZE (IN.)	EMT SIZE (IN.)	FLEX SIZE (IN.)	DIMENSIONS (IN.)		STD. CTN.
				A	B	
N-101-SC	—	1/2	3/8	2 5/32	1 5/64	1,000
N-102-SC	1/2	3/4	1/2	2 5/16	1 7/32	1,000
N-103-SC	3/4	1	—	2 3/8	1 15/32	1,000

### Flange Plates — Malleable Iron/ Zinc Plated

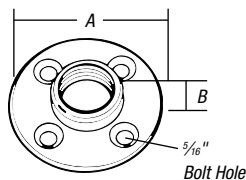

CAT. NO.	CONDUIT SIZE (IN.)	DIA. A (IN.)	DEPTH B (IN.)	STD. CTN.
FP-402	3/4	3 3/8	.656	50
FP-403	1	3 3/8	.765	50
FP-404	1 1/4	4	.875	25
FP-405	1 1/2	4 3/8	.937	25
FP-406	2	4 3/8	.843	25

### Pipe Spacers for Rigid/Intermediate or Thinwall — Die-Cast Zinc

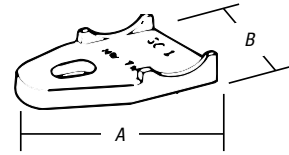

CAT. NO.	CONDUIT SIZE (IN.)	DIA. A (IN.)	DEPTH B (IN.)	STD. CTN.
CB-201	1/2	2	1	1,000
CB-202	3/4	2 3/8	1 1/16	500
CB-203	1	2 3/4	1 1/16	500
CB-204	1 1/4	3 3/8	1 1/2	250
CB-205	1 1/2	3 13/16	1 3/8	100
CB-206	2	4 1/2	2	50

### Rigid/Intermediate Space Caps — Plastic

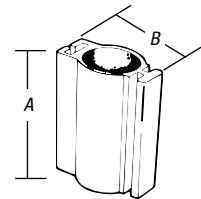

CAT. NO.	CONDUIT SIZE (IN.)	DIMENSIONS (IN.)		STD. CTN.
		A (IN.)	B (IN.)	
BR-501	1/2	2 15/32	1 21/32	100
BR-502	3/4	2 15/32	1 59/64	100
BR-503	1	2 15/32	2 1/8	100
BR-504	1 1/4	2 15/32	2 61/64	100
BR-505	1 1/2	2 15/32	3 13/64	100

### Snap-In Blanks

- Steel
- Zinc plated



CAT. NO.	CONDUIT SIZE (IN.)	DIAMETER (IN.)	STD. CTN.
BL-111	1/2	1 1/64	1,000
BL-112	3/4	1 1/4	1,000
BL-113	1	1 1/2	1,000
BL-114	1 1/4	1 13/16	500
BL-115	1 1/2	2 7/32	500
BL-116	2	2 11/16	250

### Box Spacer — Die Cast Zinc (1/4" Space)

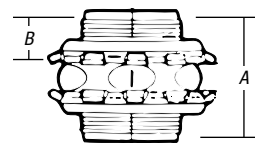

CAT. NO.	CONDUIT SIZE (IN.)	DIMENSIONS (IN.)		STD. CTN.
		A	B	
BS 201	1/2	1 1/8	1 3/32	500

UL File No. E-23018.