

Specification Grade Insulated Bushings

For Rigid Metal Conduit, IMC & EMT

Types B, HB, AB, RB, SB, SBT

Use:

To protect insulated conductors from abrasion during pulling and from mechanical vibration.

To provide voltage gradient between live conductors and ground at point of electrical and mechanical stress on conductor insulation.

Features:

- Molded-on high impact phenolic thermosetting insulation
- UL insulation temperature rating 150°C
- Positive metallic conduit stop

Material/Finish:

For Threaded Rigid and IMC

Type B: ½" & ¾" - Steel, Zinc Plated

1" to 6" - Malleable Iron, Zinc Plated

Type HB: ½" & ¾" - Steel, Mechanical/Hot Dip Galvanized

1" to 6" - Malleable Iron, Mechanical/Hot

Dip Galvanized

Type AB: Aluminum Bushing

Type RB: Bronze, for highly corrosive atmospheres

For Threadless Rigid and IMC

Type SB: ½" & ¾" - Steel, Zinc Plated with Stainless Steel screws

1" to 6" - Malleable Iron/Zinc Plated with Stainless Steel screws

For EMT

Type SBT: ½" & ¾" - Steel, Zinc Plated with Stainless Steel screws

1" to 6" - Malleable Iron/Zinc Plated with Stainless Steel screws

Options:

Type B insulated bushings are also available for threadless rigid and IMC in the following materials:

Type HSB: Malleable Iron or Steel
Mechanical/Hot Dip Galvanized

Type ASB: Aluminum

Type RSB: Bronze

Third Party Certification:



UL Listed: E-11853



CSA Certified: 011584

Applicable Third Party Standards:

UL Standard: 514B

CSA Standard: C22.2 No. 18

Fed. Spec: W-F-408E

NEMA: FB-1

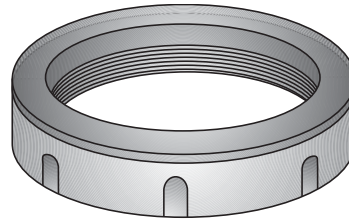

**Type B
Threaded**

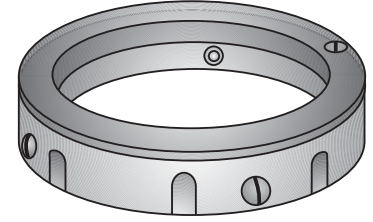

**Type SB
Threadless**

Threaded for Rigid Conduit & IMC Catalog Numbers					Threadless Rigid & IMC Catalog Numbers	EMT Catalog Numbers
Trade Size (inches)	Malleable Iron or Steel/ Zinc Plated	Hot-Dip Mechanical Galvanized	Copper Free Aluminum	Bronze	Malleable Iron or Steel/ Zinc Plated	Malleable Iron or Steel/ Zinc Plated
½	B-50	HB-50	AB-50	RB-50	SB-50	SBT-50
¾	B-75	HB-75	AB-75	RB-75	SB-75	SBT-75
1	B-100	HB-100	AB-100	RB-100	SB-100	SBT-100
1¼	B-125	HB-125	AB-125	RB-125	SB-125	SBT-125
1½	B-150	HB-150	AB-150	RB-150	SB-150	SBT-150
2	B-200	HB-200	AB-200	RB-200	SB-200	SBT-200
2½	B-250	HB-250	AB-250	RB-250	SB-250	SB-250
3	B-300	HB-300	AB-300	RB-300	SB-300	SB-300
3½	B-350	HB-350	AB-350	RB-350B	SB-350	SB-350
4	B-400	HB-400	AB-400	RB-400	SB-400	SB-400
5	B-500	HB-500	AB-500	RB-500	SB-500	
6	B-600	HB-600	AB-600	RB-600	SB-600	

Note:

1 A Mechanically Galvanized finish provides a plating thickness equivalent to Hot-Dip process, meeting ASTM A-153 performance criteria.

Unlike the Hot-Dip process, mechanical galvanizing provides plating on all machined and/or threaded surfaces.

2 Caps to prevent entry of foreign matter into conduit prior to pulling cables are available.

See Type PPC on page DB1.

Suggested Specification:

O-Z/Gedney Type B insulated bushings of malleable iron or steel, with conduit end stop and integrally molded noncombustible phenolic insulated surfaces rated 150°C shall be used on the ends of all raceways containing No. 4 or larger conductors.

Trade Size (inches)	Dimensions in Inches	
	Max. Dia.	Overall Height
½	1⅛	1½
¾	1⅝	⅝
1	1⅞	¾
1¼	2	¾
1½	2¼	¾
2	2¾	⅞
2½	3¼	1
3	4	1
3½	4½	1
4	5	1⅛
5	6¼	1¼
6	7⅞	1⅝